

ACCESS & STRIPING EXHIBIT
WASHINGTON BLVD
NCRSP - PARCEL 49
 MAJOR PROJECT PERMIT - STAGE 1
 ROSEVILLE, CA

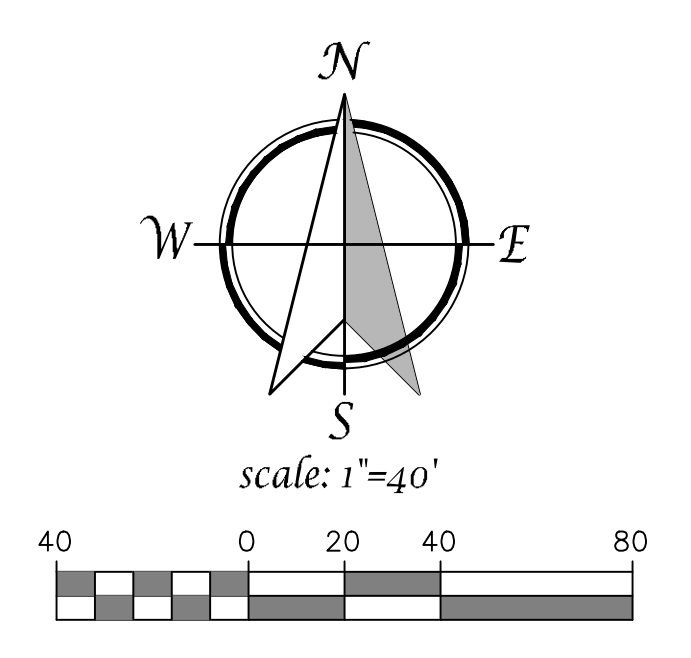
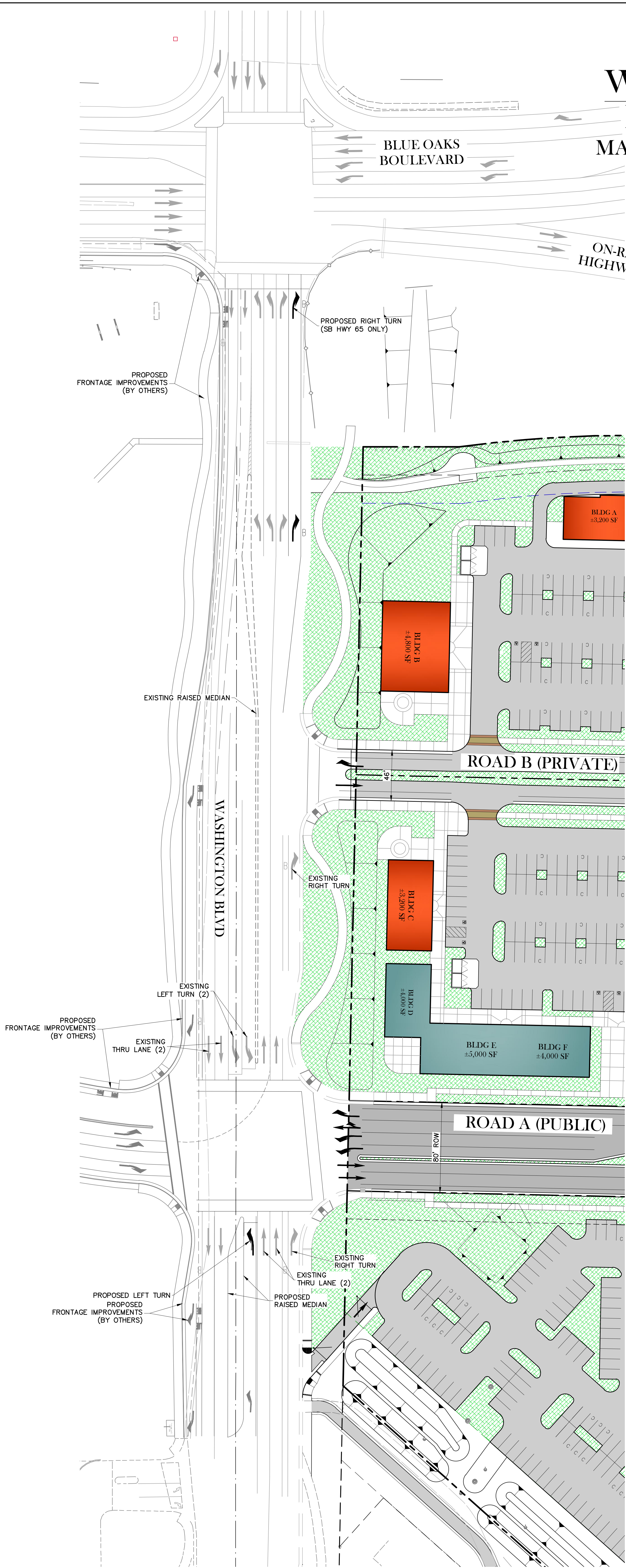

MAJOR PROJECT PERMIT – STAGE 1
 ACCESS & STRIPING EXHIBIT
 DECEMBER 09, 2014

TSD ENGINEERING, INC.
 expect more.
 31 Natoma Street, Suite #160
 Folsom, CA 95630
 Phone: (916) 608-0707
 Fax: (916) 608-0701